

1. Electric Characteristics.

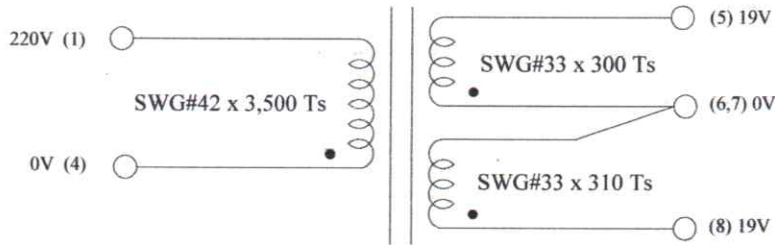

2. Configuration and Dimension.

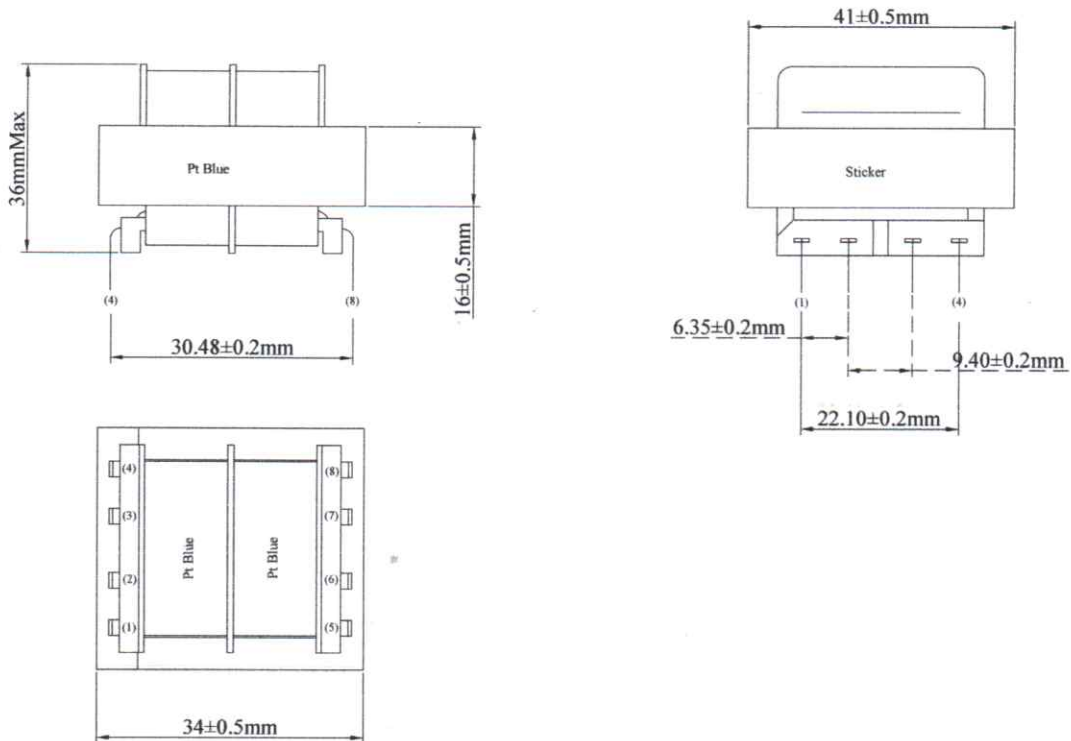

Material		
Item	Material	Description
1	Bobbin	Nylon
2	Copper wire	2UEW
3	Insulation tape	0.025mm
4	Laminations Steel	EI-41-S23 x 0.50mm
5	Insulation Pb	0.18 mm
6	Varnish	Hi-term Bc-359
7	Lead free Solder bar	60/40 Sn / Pb

Input and Output Voltage (±3%). No load.	
Input	Pin 4 and Pin 1 = 220V 50/60Hz
Output	Pin 6,7 and Pin 8 = 19VAC
Output	Pin 8 and Pin 6,7 = 19VAC
High Potential Test.	
Apply AC 1.5 KV 1mA, Coil to Core and Coil to Coil, or 1Munite. and Should not be any abnormality.	
Remaks.	
Print code, date of manafactury. Stack the lamination steel EI-41 one by one.	

EAST ELECTRIC ACCESSORY CO.,LTD.

220/2 Saiwadcok Road Tambon Bangprok Amphur Muang Pathoomthanee 12000

Tel : +662 (02) 5811621-4 Fax : +662 (02) 5811620

www.eea - trafo.com E-mail : eea-trafo@hotmail.com

(052000056)

Customer : ELECTRONICS SOURCE	EEA Part No. : 41160416	Prepared by :
Customer Approved by :	Model : 11500	Approved by :
Position :	Revision : 1	Date : April 02 , 2009